

# **GALASSI&ORTOLANI**

**VALVESMANUFACTUREDIVISION**



PINCHVALVES  
BUTTERFLYVALVES  
DIAPHRAGMVALVES  
CHECKVALVES  
BALLVALVES  
GATEVALVES  
**THERMOPLASTICVALVES**

**The answer to problems of:  
corrosion, abrasion, clogging, contamination.**

## **G&O THERMOPLASTIC VALVES**

Galassi & Ortolani has permanently resolved the problems for piping system of steel industries, Chloralkali projects and many other chemical plants with introduction of right material of construction for their most aggressive and corrosive applications.

### **PRODUCT FEATURES:**

**Diaphragm valves:** Weir type, conveyed flow – Flanged Ends, NPT Ends & SW / BW Ends

Flanged Valves sized from 1/2" through 6"; NPT / SW / BW Ends sized from 1/2" through 3"

Manual, Pneumatic and Electric actuated.

**Butterfly Valves:** To mount between flanges ANSI/BS/DIN/JIS

Sized from 2" through 24"

Manual, Pneumatic and Electric actuated.

**Ball valves:** To mount between flanges ANSI/BS/DIN/JIS

Sized from 1/2" through 6"

Manual, Pneumatic and Electric actuated.

**Check valves:** To mount between flanges ANSI/BS/DIN/JIS

Sized from 1" through 8"

### **PERFORMANCE FEATURES:**

- Quick and easy replacement of the trim
- No maintenance
- Long durability

### **BODY VALVE MATERIALS:**

- Diaphragm Valves: PP/ISO.PP/PPH/PVDF
- Butterfly Valves: PP/ISO. PP /PVDF/UPVC/CPVC
- Ball valves: PP/ISO.PP/PVDF/ETFE
- Check valves: PP/ISO.PP/PVDF/ETFE

### **Trim Materials:**

- Diaphragm Valves:  
NEOPRENE/EPDM/PTFE+EPDM/PTFE+PVDF+EPDM
- Butterfly Valves: PP/ISO.PP/PVDF/UPVC/CPVC
- Ball valves: PP/ISO. PP/PVDF/ETFE
- Check valves: PP/ISO.PP/PVDF/ETFE



**DESIGN/DIMENSIONS APPLICABLE STANDARD**

- As per manufacturer standard

**CERTIFICATES AVAILABLE**

- EN 10204 3.1.

**INSPECTION TESTS AVAILABLE BY:**

- SGS GLOBAL TRADE SOLUTIONS
- ITS INTERTEK TESTING SERVICES
- BV BUREAU VERITAS

**MAJOR MARKETS SERVED**

- Chlor Alkali plants
- Cold Rolling Mills & Steel Industries
- Chemical and pharmaceutical Industries

**OPTIONS:**

- Limit switches
- Solenoid valve
- Position indicator
- Air filter regulator
- 3:15 PSI positioner
- 4:20mA electro pneumatic positioner or 4:20mA electronic transmitter of position 30°-90° angle
- Mono/Triphase AC motor (240V/50Hz through 400V/50Hz)



## MANUAL DIAPHRAGM VALVES

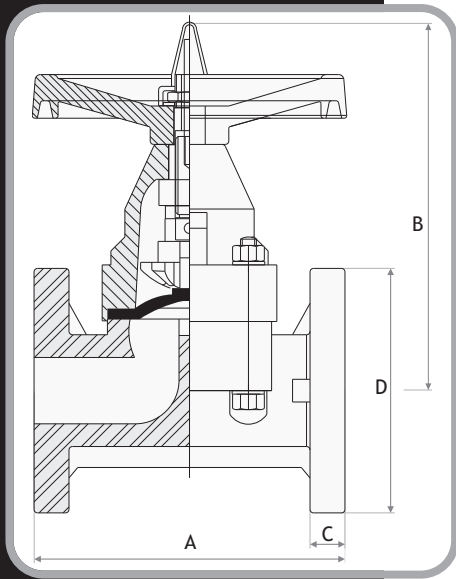

| Size mm | A (+/- 3 mm) | B   | C  | D   |
|---------|--------------|-----|----|-----|
| 15      | 120          | 95  | 17 | 95  |
| 20      | 150          | 150 | 17 | 120 |
| 25      | 150          | 150 | 17 | 120 |
| 40      | 178          | 205 | 18 | 140 |
| 50      | 213          | 215 | 19 | 160 |
| 65      | 280          | 285 | 24 | 200 |
| 80      | 280          | 285 | 24 | 200 |

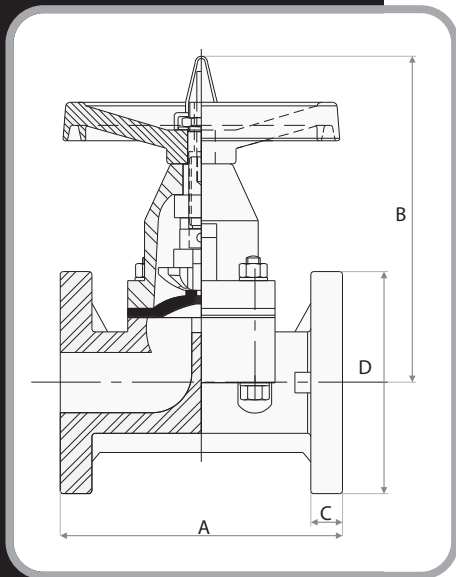

| Size mm | A (+/- 3 mm) | B   | C  | D   |
|---------|--------------|-----|----|-----|
| 100     | 312          | 380 | 23 | 228 |
| 150     | 408          | 525 | 26 | 280 |

## MANUAL BUTTERFLY VALVE LEVER TYPE

| Size mm | A   | B   | C  | D   |
|---------|-----|-----|----|-----|
| 50      | 253 | 160 | 42 | 220 |
| 65      | 260 | 182 | 42 | 215 |
| 80      | 286 | 200 | 46 | 220 |
| 100     | 309 | 229 | 54 | 215 |
| 125     | 383 | 250 | 66 | 310 |
| 150     | 430 | 280 | 74 | 310 |
| 200     | 475 | 338 | 88 | 415 |

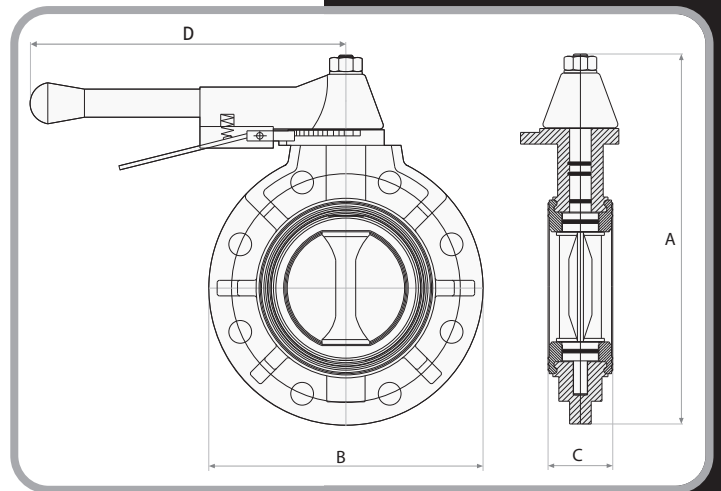

## MANUAL BUTTERFLY VALVE GEAR OPERATED

| Size mm | A   | B   | C   | D   |
|---------|-----|-----|-----|-----|
| 150     | 384 | 280 | 74  | 240 |
| 200     | 441 | 340 | 87  | 240 |
| 250     | 503 | 400 | 111 | 240 |
| 300     | 642 | 495 | 126 | 240 |
| 350     | 665 | 514 | 132 | 244 |
| 400     | 753 | 594 | 169 | 252 |
| 450     | 803 | 634 | 181 | 269 |
| 500     | 878 | 704 | 190 | 330 |
| 600     | 984 | 805 | 209 | 330 |

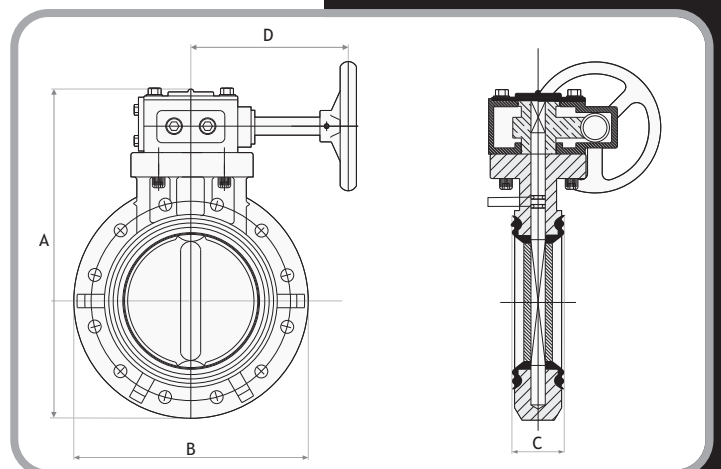

## MANUAL BALL VALVE FLANGED ENDS

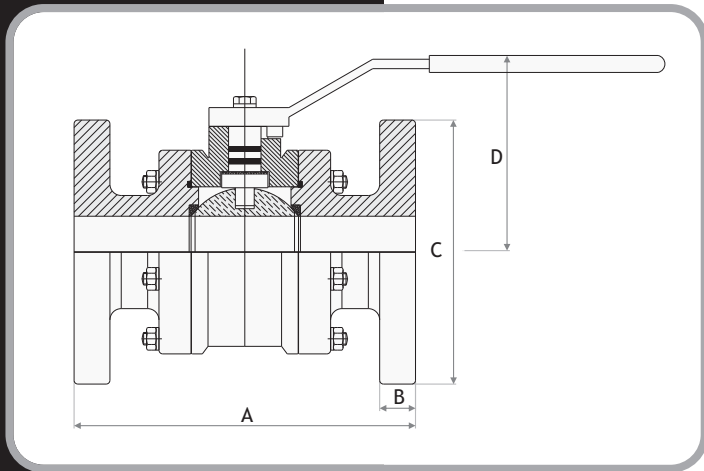

| Size mm | A   | B  | C   | D   |
|---------|-----|----|-----|-----|
| 15      | 132 | 17 | 95  | 70  |
| 20      | 138 | 17 | 114 | 80  |
| 25      | 158 | 17 | 120 | 100 |
| 40      | 182 | 17 | 140 | 105 |
| 50      | 212 | 19 | 165 | 120 |
| 65      | 238 | 22 | 180 | 133 |
| 80      | 255 | 23 | 203 | 145 |
| 100     | 298 | 23 | 230 | 175 |
| 150     | 415 | 30 | 305 | 253 |

## MANUAL BALL VALVE THREADED ENDS

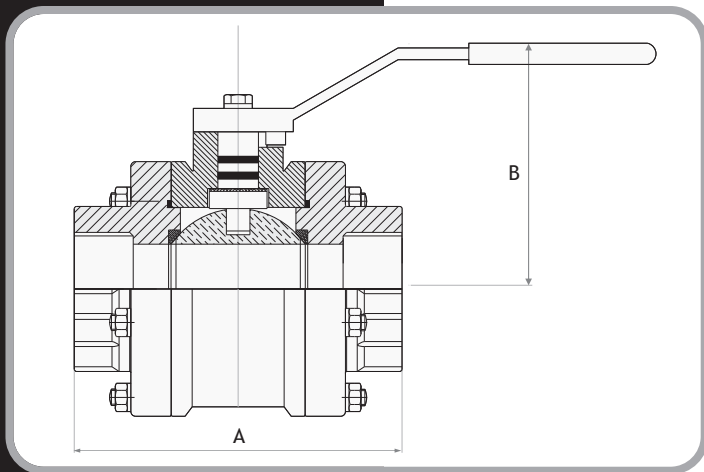

| Size mm | A   | B   |
|---------|-----|-----|
| 15      | 105 | 70  |
| 20      | 110 | 80  |
| 25      | 135 | 100 |
| 40      | 132 | 105 |
| 50      | 160 | 120 |

## CHECK VALVES BALL TYPE

| Size mm | A (+/- 3 mm) | B   | C  |
|---------|--------------|-----|----|
| 25      | 140          | 120 | 17 |
| 40      | 175          | 140 | 17 |
| 50      | 212          | 165 | 19 |
| 65      | 245          | 203 | 23 |
| 80      | 245          | 203 | 23 |
| 100     | 300          | 230 | 23 |
| 150     | 355          | 280 | 29 |

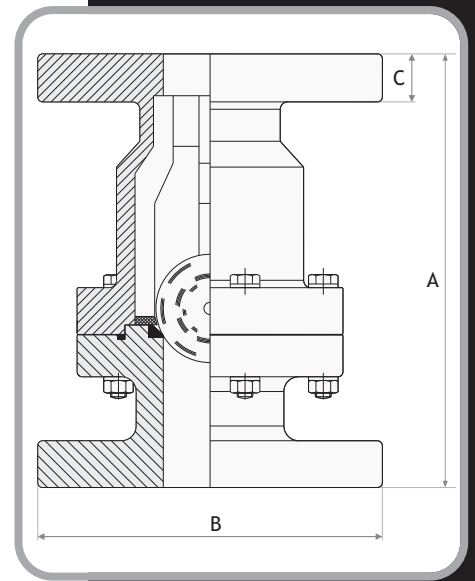

**GALASSI&ORTOLANI**  
VALVES MANUFACTURE DIVISION

## SWING CHECK VALVES WAFER TYPE

| Size mm | A (+/- 3 mm) | B   | C  |
|---------|--------------|-----|----|
| 100     | 168          | 85  | 35 |
| 150     | 216          | 110 | 40 |
| 200     | 272          | 144 | 40 |

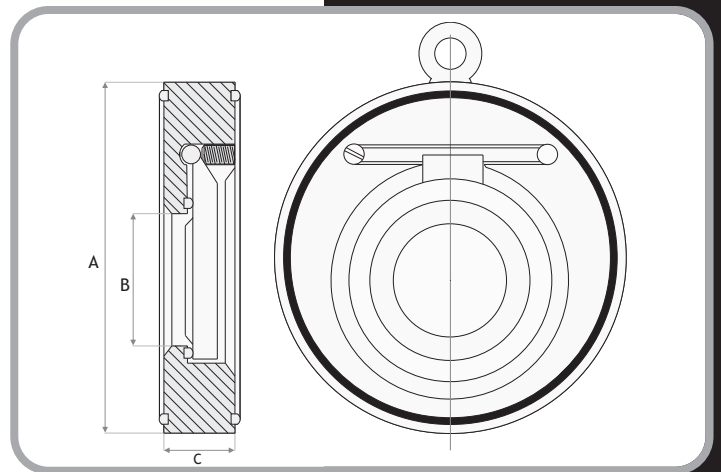

Galassi & Ortolani Spa has been making special valves since 1937.

The range of products, comprising:

- diaphragm valves
- pinch valves
- butterfly valves
- check valves
- pneumatic actuators
- ball valves
- gate valves
- thermoplastic valves

is divided into several versions and variants and is used, in particular, in the chemical industry, in water processing and distribution.

The experience achieved during over 75 years in the making of valves for various-nature fluid-management plants has allowed Galassi & Ortolani to make a name in the plant-construction market as a reference producer both at domestic and international level.

#### ARTISANS OF YEAR 2000

- Uni En ISO 9001 Quality Management System Certified
- Choice of ISO certified suppliers who utilize the latest casting technologies
- Check of all incoming components so as to find and eliminate those defective
- Check of all machined products for conformance to our dimensional standards
- Hydraulic test of body valve at 110/115% of rated pressure to ensure the best tightness
- Each valve being coated with an anti-corrosive varnish at no additional cost

#### CNC PROCESS

Equipment for Machining Centres and CN Lathes

- To have the utmost control possible on each component
- To allow total interchangeability of each component in case it is changed
- To ensure valve perfect stability and connection
- To reduce Torque rating

#### CUSTOMER HELP

- Customer's personalized treatment, both pre-sales and after-sales
- Direct intervention by our experts on Plants upon request
- Extensive store of spare parts for immediate availability



ISO 9001:2000  
Registr. n° IT 44453

### GALASSI & ORTOLANI

VALVES MANUFACTURE DIVISION

GALASSI & ORTOLANI SpA  
Via Ghirlandaio, 2/4 - 20096 Pioltello (MI) Italy  
Tel. +39 02.92103459 - 02.92103801 - 02.92103802 - Fax +39 02.92103804  
E-mail: info@galassiortolani.com - www.galassiortolani.com